



FUEL MODIFICATION NOTES:

Shrub species or groundcovers within tree driplines will be maintained under 36" height max to deter fuel ladder's.

All restoration hydroseed areas: Baccharis pilularis, Artemesia californica, Eriogonum fasciculatum will be maintained at 3' high max & within tree dripline or removed completely from below trees as maturity occurs.

PLANT SCHEDULE

SHRUBS	BOTANICAL NAME	COMMON NAME
AL	Acacia redolens 'Lowboy'	Bank Catclaw
A	Agave filifera	Thread Leaf Agave
A	Agave ovatifolia 'Frosty Blue'	Whale's Tongue Agave
C	Callistemon viminalis 'Little John'	Dwarf Weeping Bottlebrush
CO	Cotoneaster dammeri	Bearberry Cotoneaster
E	Eremophila glabra 'Mingenew Gold'	Emu Bush
H	Hesperaloe parviflora	Red Yucca
(H)	Hesperaloe parviflora	Red Yucca
(M)	Muhlenbergia capillaris 'Lenca'	Regal Mist Pink Muhly
S	Salvia grahamii	Graham's Sage
(SC)	Senna artemisioides	Feathery Cassia
T	Tecoma stans	Yellow Belts
W	Westringia fruticosa	Coast Rosemary
(W)	Westringia fruticosa 'Morning Light'	Morning Light Coast Rosemary
Y	Yucca schidigera	Mohave Yucca
NATIVE SHRUBS	BOTANICAL NAME	COMMON NAME
B	Baccharis pilularis 'Pigeon Point'	Coyote Brush
(B)	Baccharis 'Starn Thompson'	Starn Thompson Baccharis
CE	Ceanothus x 'Julia Phelps'	California Lilac

(CER)	Cercis occidentalis	Western Redbud Multi-trunk
(He)	Heteromeles arbutifolia	Toyon
(M)	Muhlenbergia rigens	Deer Grass
(P)	Penstemon barbatus 'Pink'	Pink Beard Tongue
(RH)	Rhamnus californica	California Coffee Berry
(R)	Rhus integrifolia	Lemonade Berry
(R)	Rhus ovata	Sugar Bush
GROUND COVERS	BOTANICAL NAME	COMMON NAME
(H.S. Mix 'A')	H.S. Mix 'A'	Hydroseed Mix 'A'
(H.S. Mix 'B')	H.S. Mix 'B'	Hydroseed Mix 'B'

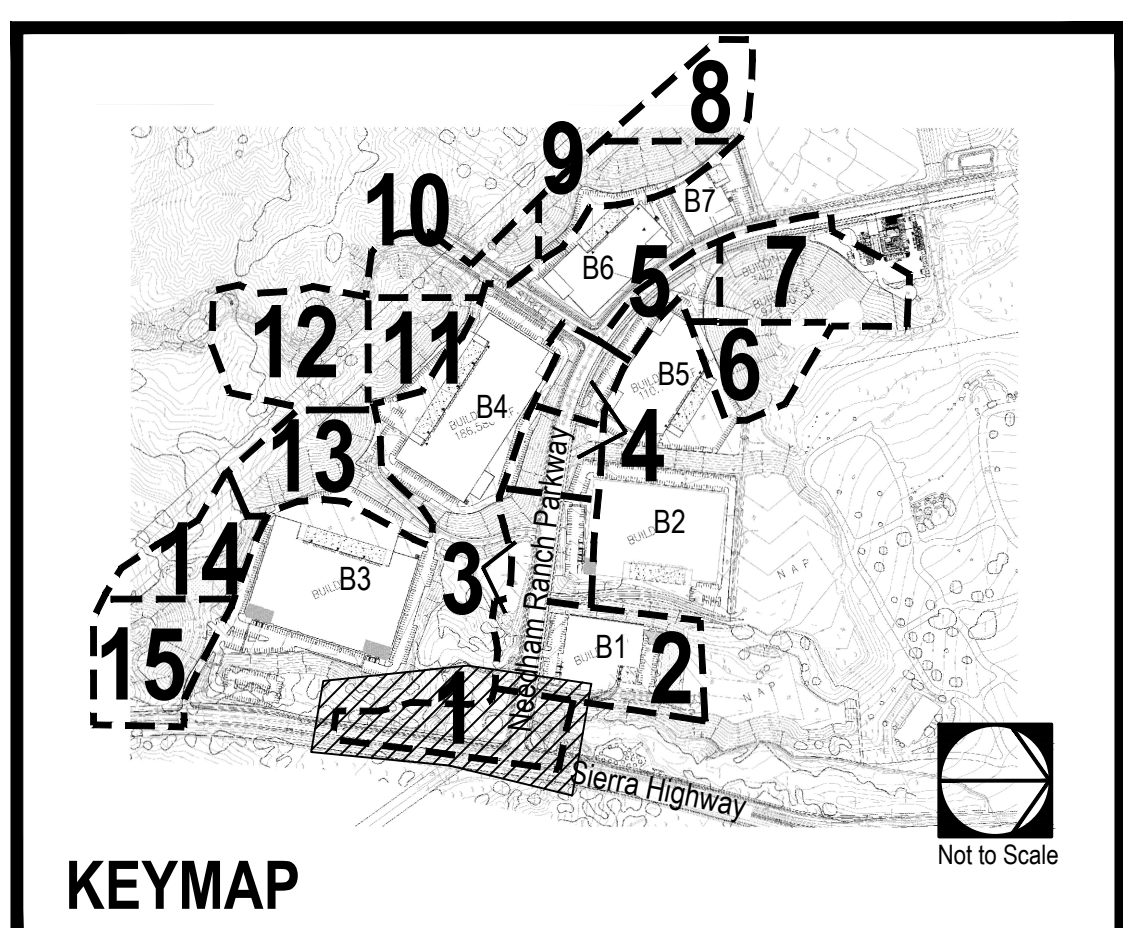

FUEL MODIFICATION ZONE

- A** Zone A - Setback Zone: (shown 20' wide)
Min. 20' wide clear area next to structures and permanently irrigated.
- B** Zone B - Irrigation Zone/Transition Zone: (shown 80' wide)
Min. 20FT wide to 80FT area next to Zone A (up to 100FT from structures). Also includes engineered slopes. Permanently irrigated.
- C** Zone C - Native Brush Thinning Zone: (shown 100' wide)
Min. 50 FT to 100 FT wide area next to Zone B (up to 200 FT from structures).

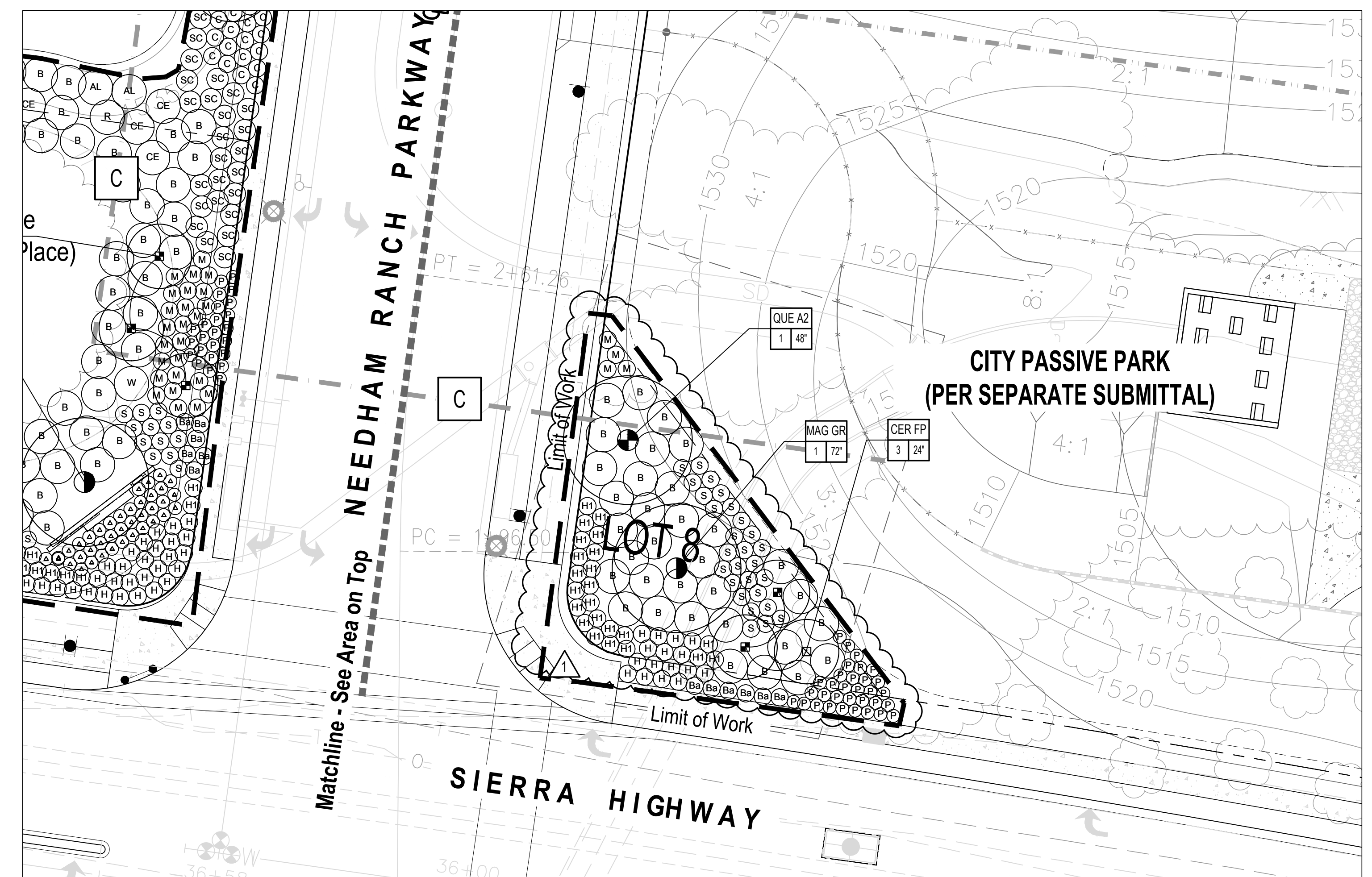
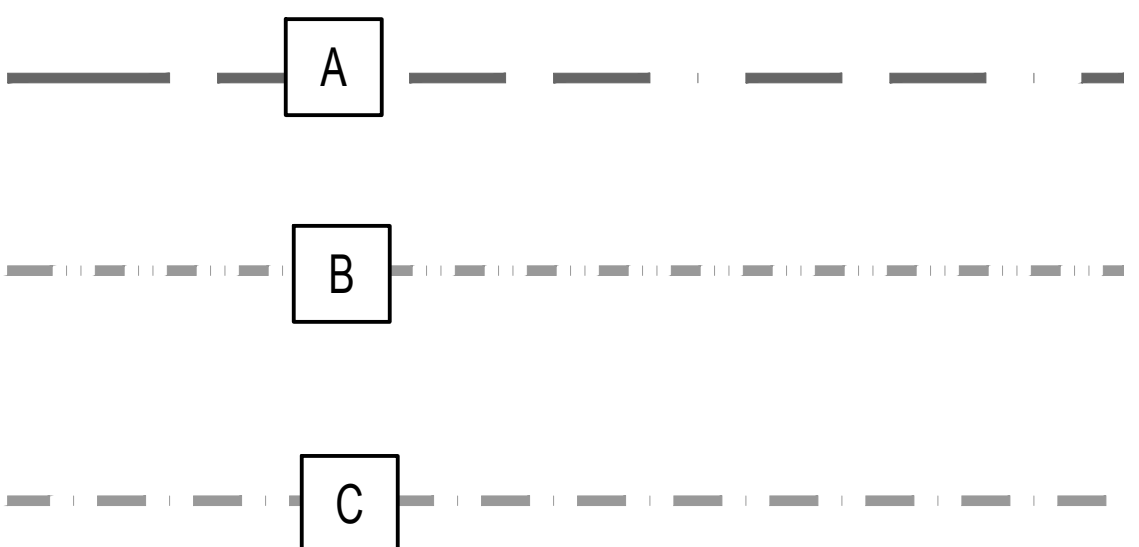

NOTES:

- A. Refer to Sheet LP-0.01 for Master Planting Schedules and Notes.
- B. Planter drains and lines to be installed 3' away from tree trunks.
- C. Trees to be installed min. 5' away from water meter boxes and other utilities.

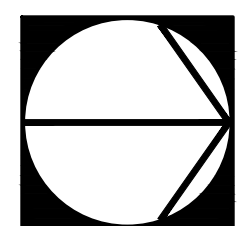
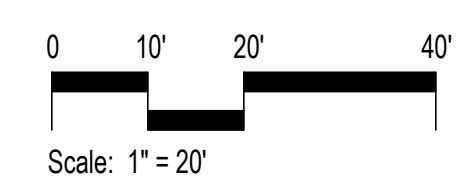

Date	Revision
2017 1215	Delta 1 Rev.

Sheet Title:

PLANTING PLAN

Job No.: ORL01_POA
Scale: 1" = 20'
Drawn: RC

Checked: PAD

Sheet Number:

LP-1.01